

VĚNEC NA -0,100

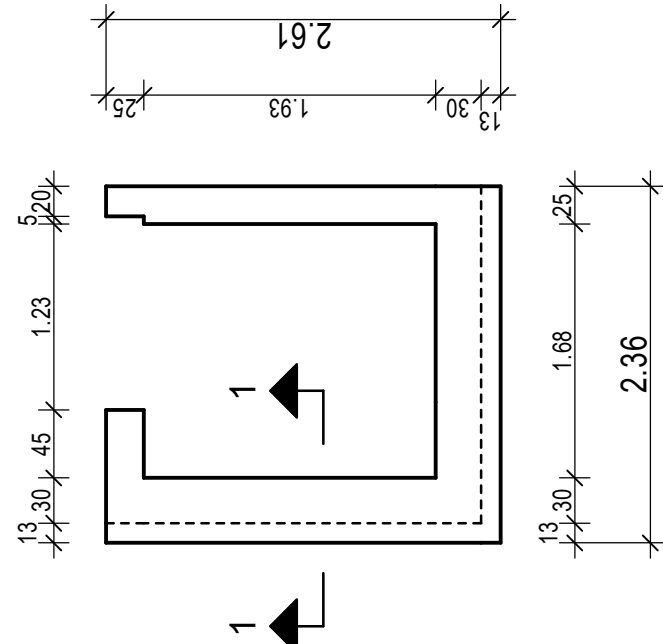

ŘEZ 1-1

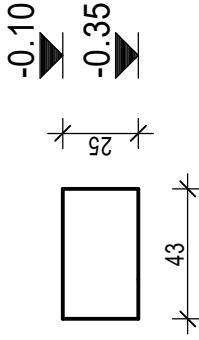

VĚNEC NA -0,100

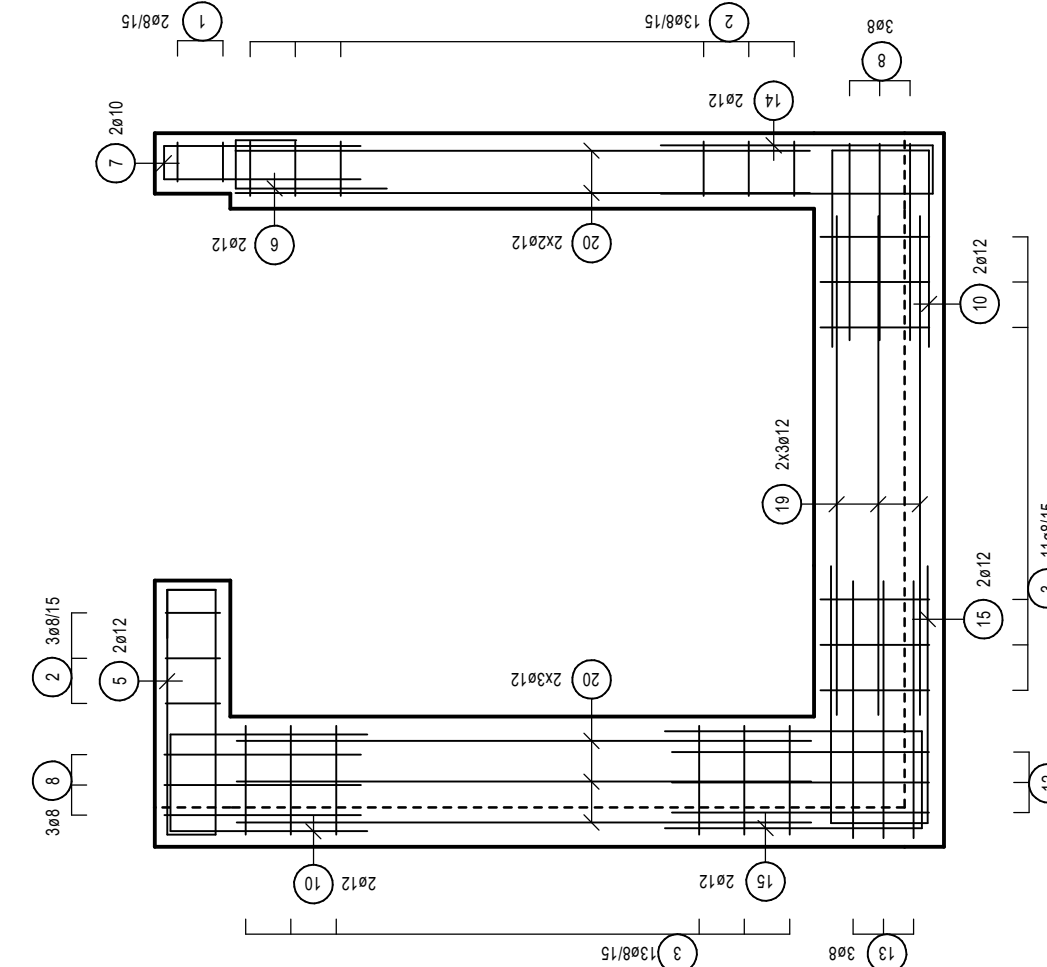

ŘEZ 1-1

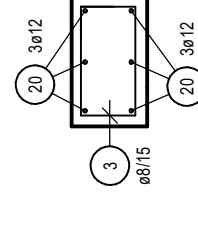

VĚNEC NA +3.42

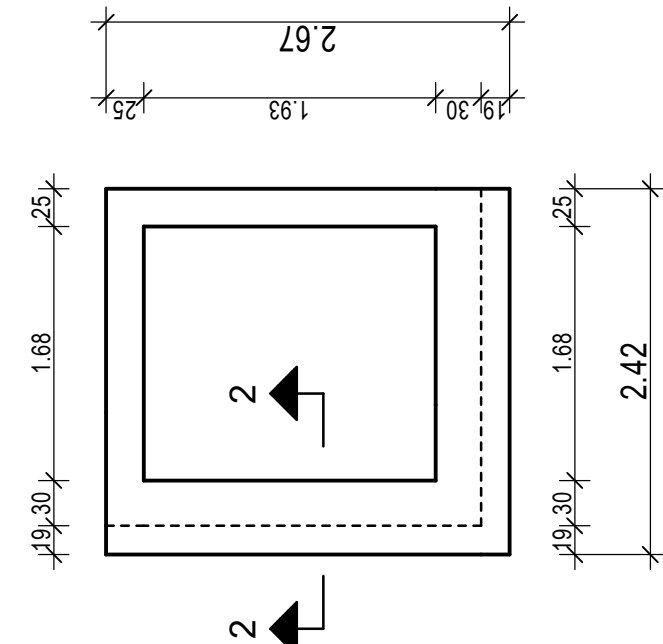

ŘEZ 2-2

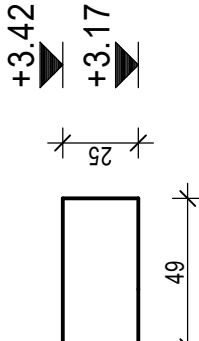

VĚNEC NA +3.42

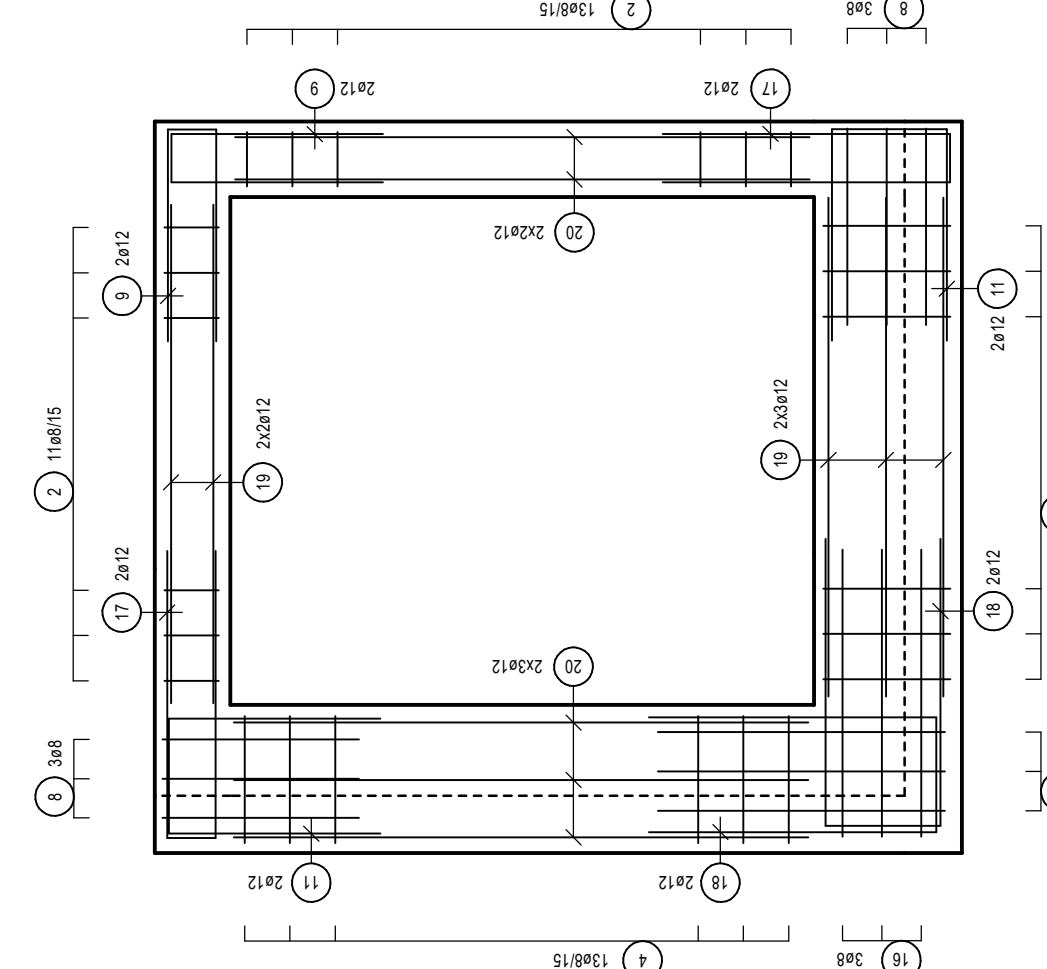

ŘEZ 2-2

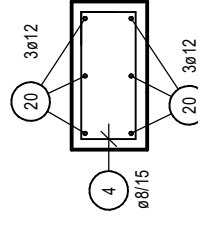

VĚNEC NA +7.00

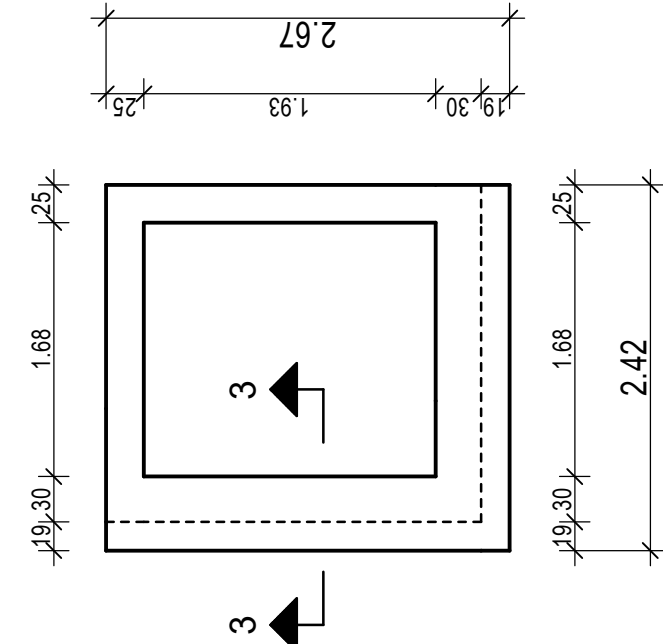

ŘEZ 3-3

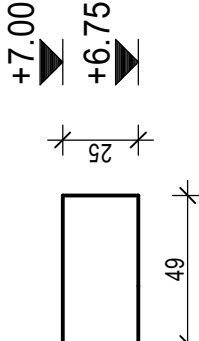

VĚNEC NA +7.00

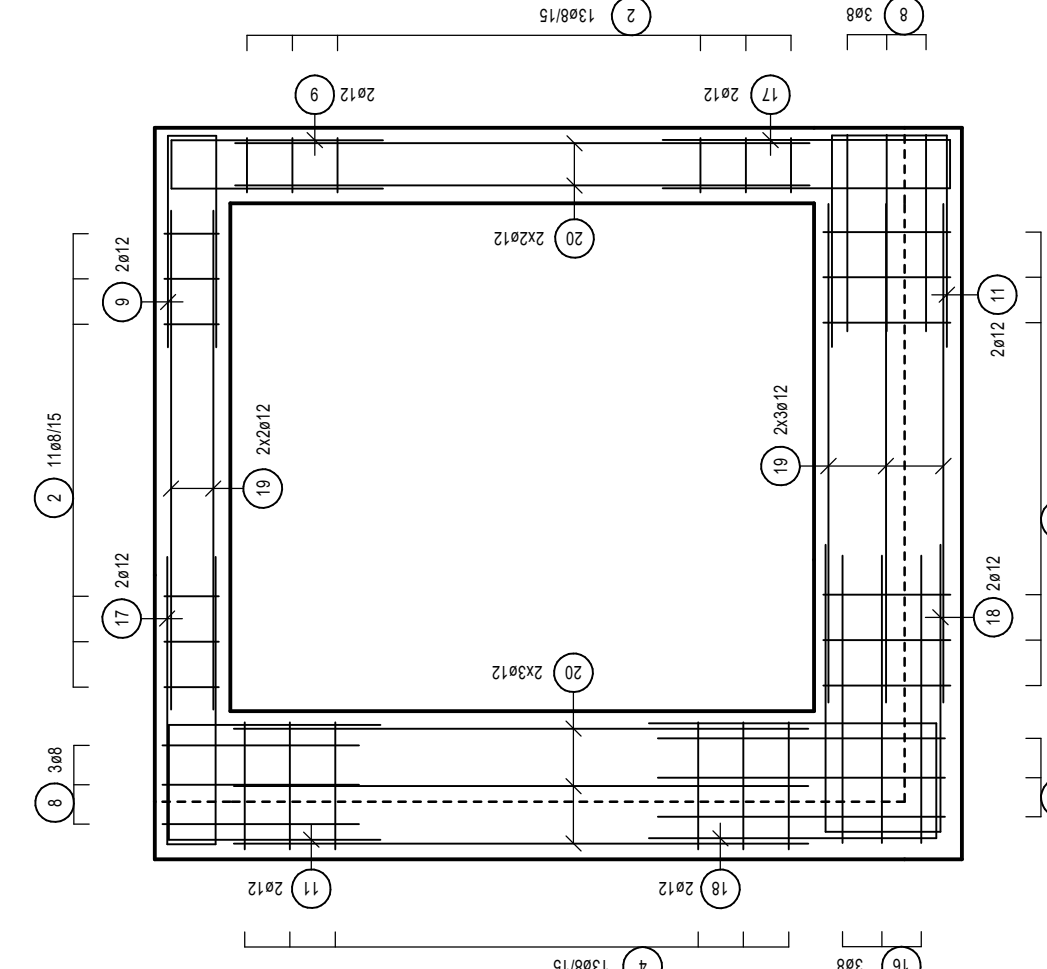

ŘEZ 3-3

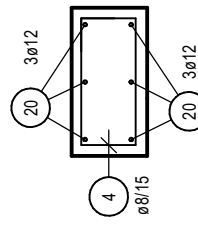

VĚNEC NA +10.35

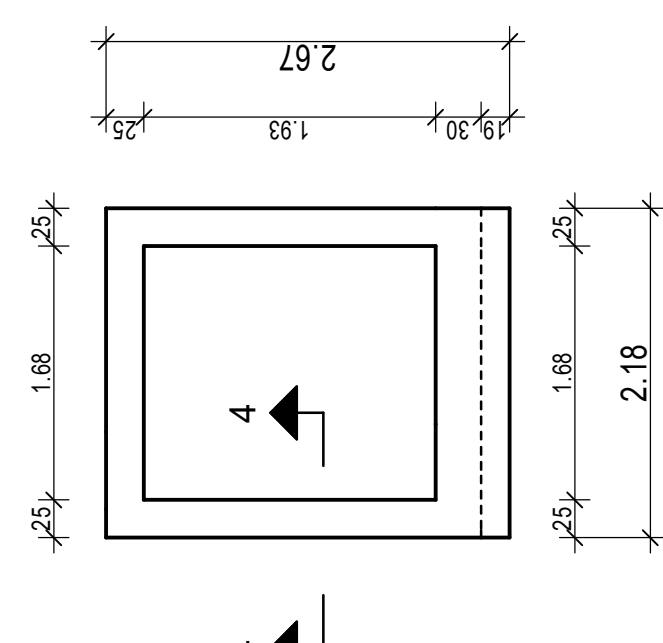

ŘEZ 4-4

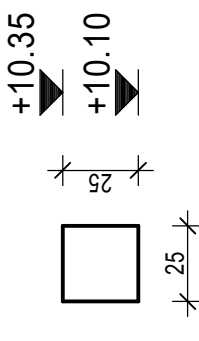

VĚNEC NA +10.35

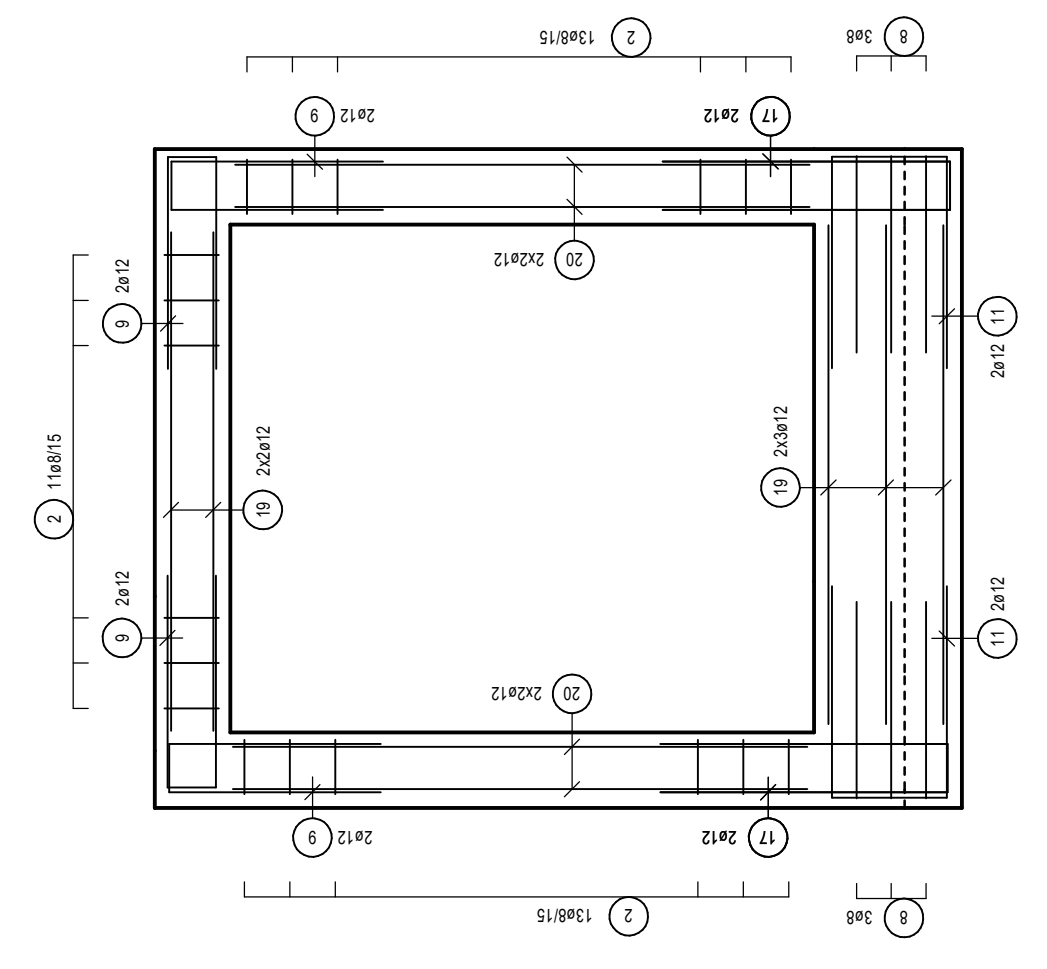

ŘEZ 4-4

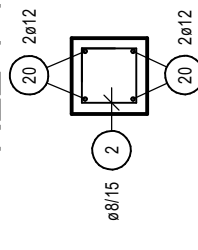

TVAR STROPU VYTAHOVÉ ŠACHTY

PŮDORYS M 1:25

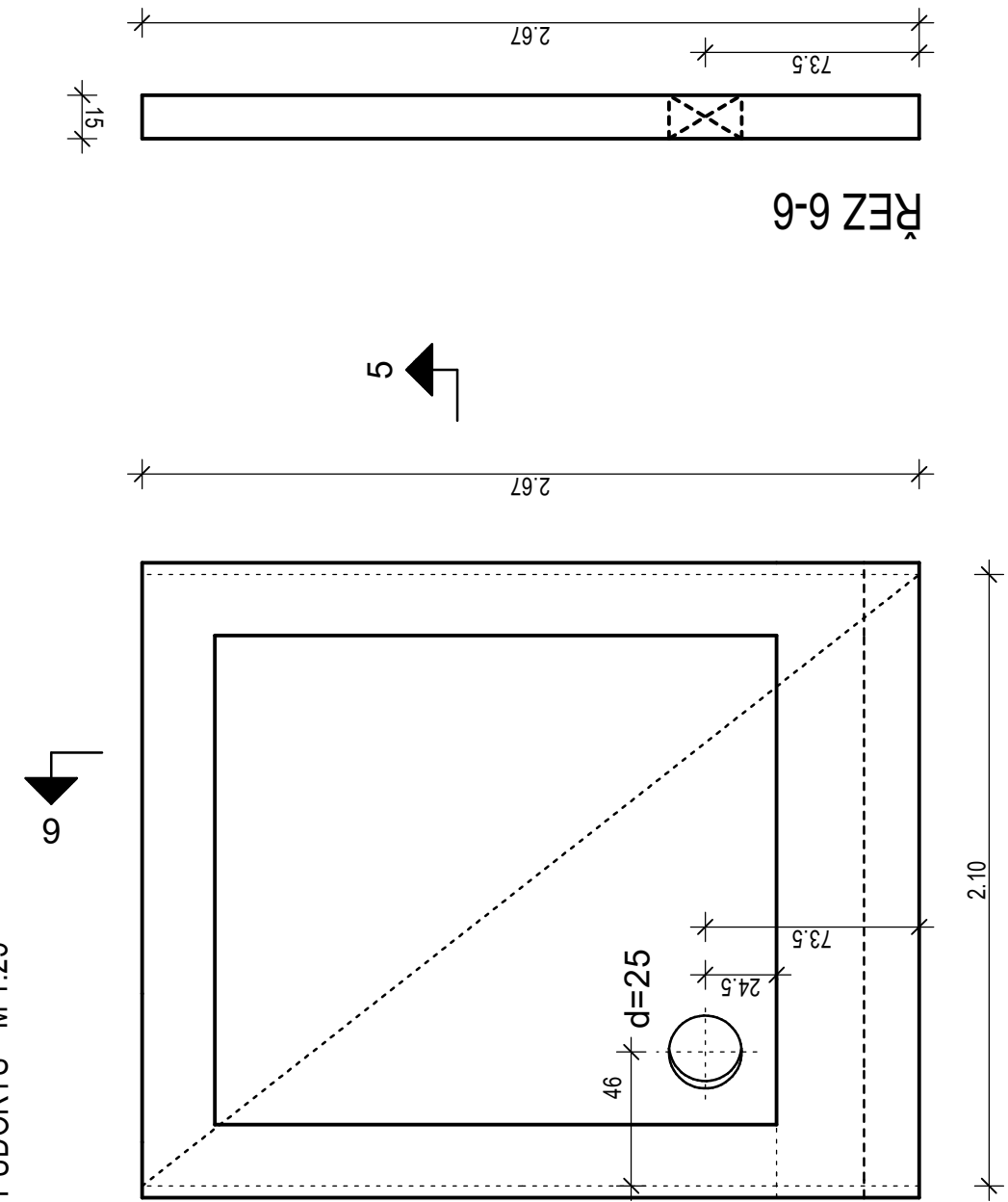

ŘEZ 5-5

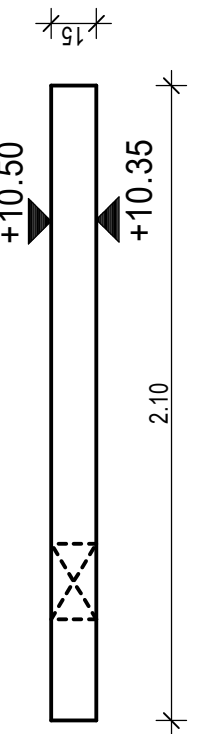

DOLNÍ VÝZTUŽ

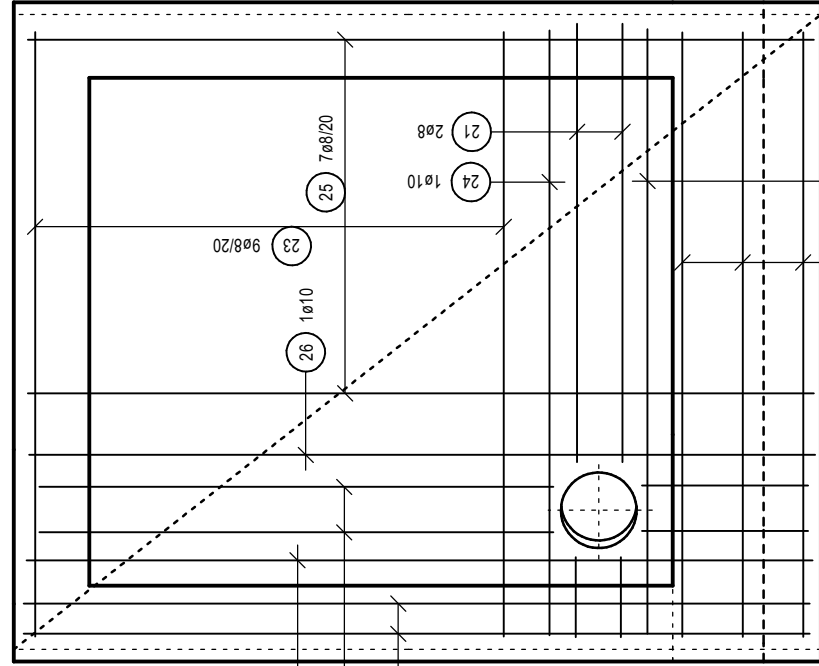

HORNÍ VÝZTUŽ LEMY

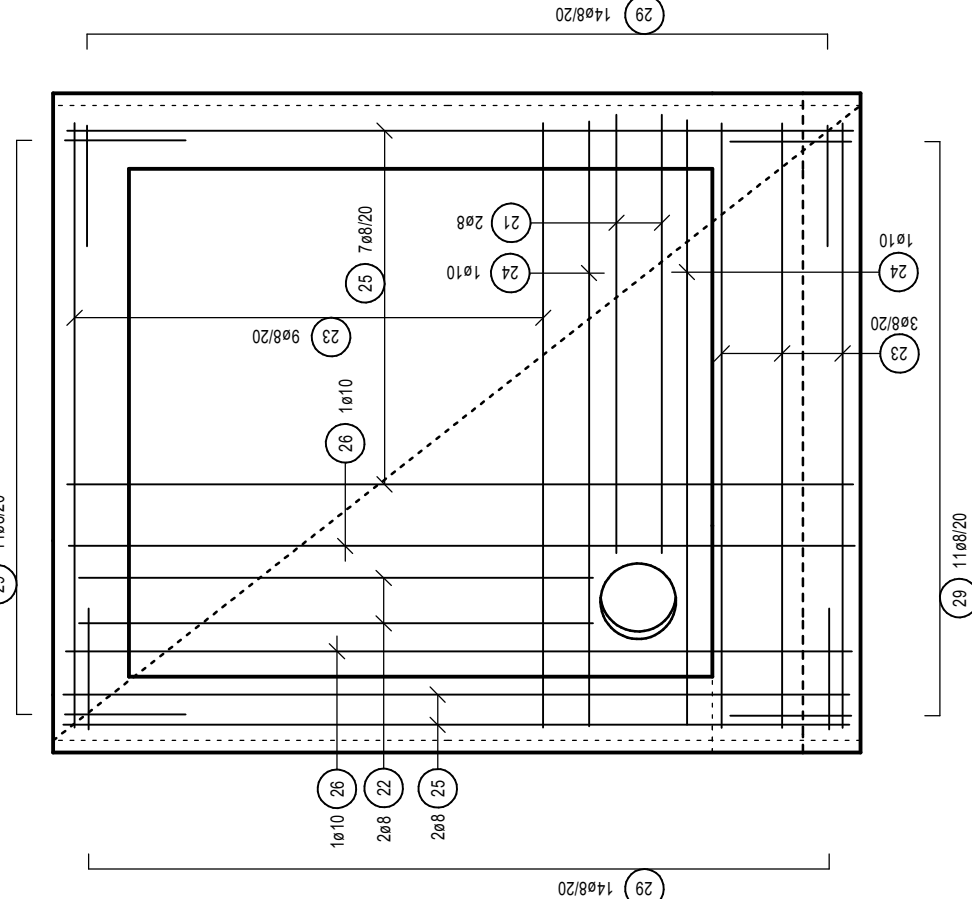

VÝPIS PRUTOVÉ VÝZTUŽE B 500 (B)

POZ.	KS	d (mm)	DELKA (m)	HMOTNOST (kg)	DELKA CELKEM (m)
1	2	8	0,840	0,332	1,680
2	101	8	0,940	0,371	94,940
3	24	8	1,300	0,514	31,200
4	48	8	1,420	0,561	68,160
5	2	12	2,280	2,007	4,520
6	2	12	2,280	2,007	4,520
7	2	10	1,410	0,870	2,820
8	24	8	1,460	0,577	35,040
9	16	12	1,560	1,385	24,960
10	4	12	1,620	1,439	6,480
11	12	12	1,620	1,439	19,440
12	3	8	1,840	0,727	5,520
13	3	8	1,860	0,735	5,580
14	2	12	1,960	1,740	3,920
15	4	12	2,020	1,794	7,080
16	12	12	2,060	1,814	24,720
17	16	12	2,060	1,829	32,960
18	8	12	2,280	2,025	18,240
19	36	12	1,650	1,465	58,400
20	38	12	1,900	1,687	72,200
21	4	8	1,450	0,573	5,800
22	4	8	1,700	0,672	6,800
23	24	8	2,000	0,790	48,000
24	4	10	2,000	1,234	8,000
25	18	8	2,600	1,027	46,800
26	4	10	2,600	1,504	10,400
27	2	8	0,950	0,375	1,900
28	2	8	1,560	0,616	3,120
29	50	8	0,950	0,352	44,500
CELKOVÉ MNOŽSTVÍ (BET. OCEL B 500 (B))					(kg)
8				423,760	167,384
16				5,584	22,720
12				253,840	225,408
HMOTNOST CELKEM					405,886